



## New Homes Hatfield Lane

Armthorpe, Doncaster, DN3 3HA

Asking Price **£279,995**

5% DEPOSIT CONTRIBUTION/ VIEW HOME COMING SOON  
PART EXCHANGE AVAILABLE UNTIL JUNE 2023

A large 3 bedroom detached house on the exclusive 'Stonebridge Homes' development on the edge of Armthorpe.

Well located for accessing the main motorway network, as well as the extensive facilities within Armthorpe.

The property offers 3 generous bedrooms, en suite shower room and utility room.

SALES OFFICE OPEN - Thursday - Monday 10:30am - 5:30pm

**\*\*SHOWHOME OPENS SATURDAY 4TH FEBRUARY\*\***

- Visit our Showhome from February 4th
- 3 generous bedrooms
- Villeroy and Boch bathroom fittings
- Porcelanosa tiling
- Lawned gardens to front and rear
- Chrome towel radiators
- Utility room
- **SHOWHOME OPENS SATURDAY 4TH FEBRUARY**

### Viewing

Please contact our Office on 01302 751616 if you wish to arrange a viewing appointment for this property or require further information.



## Floor Plan

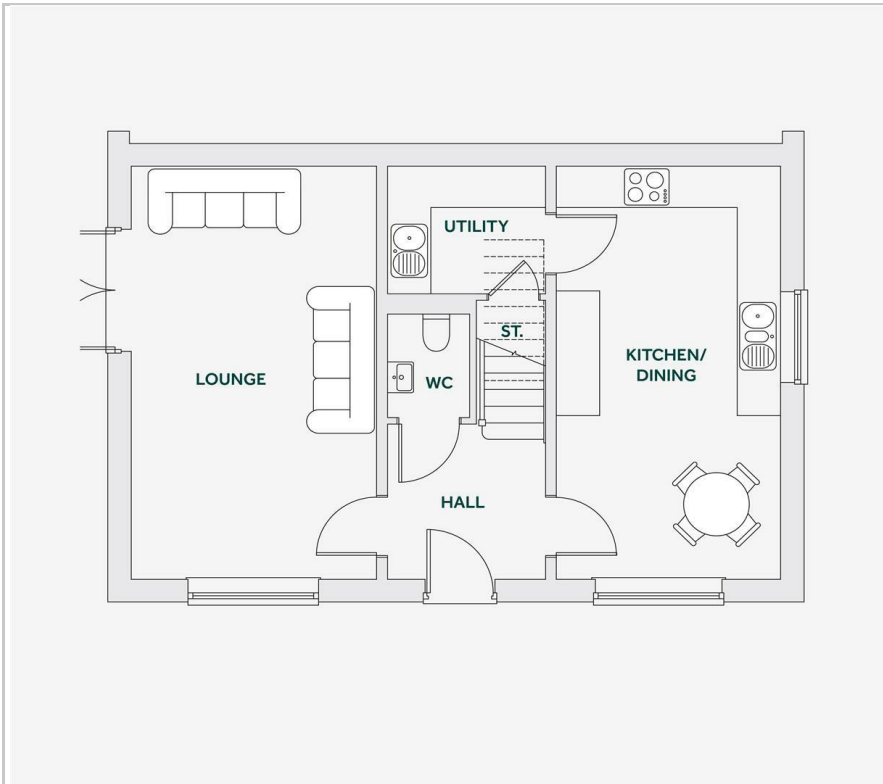

## Area Map



## Energy Efficiency Graph

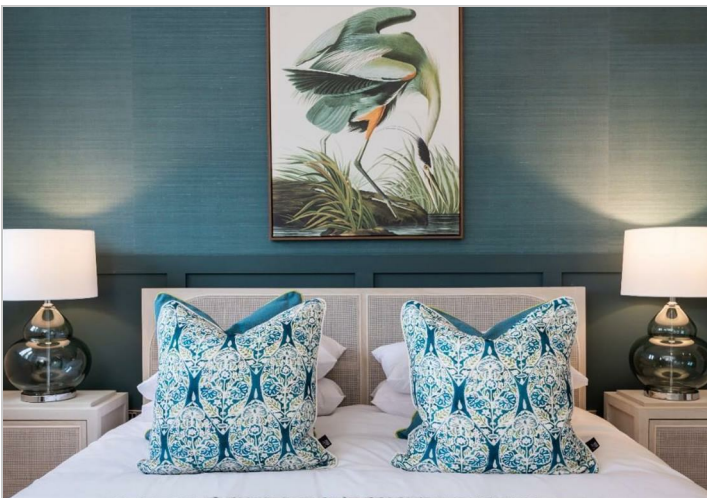
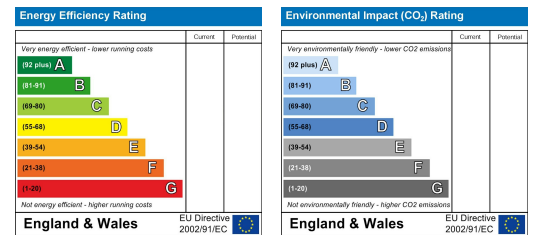

These particulars, whilst believed to be accurate are set out as a general outline only for guidance and do not constitute any part of an offer or contract. Intending purchasers should not rely on them as statements of representation of fact, but must satisfy themselves by inspection or otherwise as to their accuracy. No person in this firm's employment has the authority to make or give any representation or warranty in respect of the property.